

Magnet School for the Arts

Minnesota



Challenge:

The Anoka Hennepin School District, faced with declining enrollment, was looking for cost-effective ways to consolidate schools while maintaining a high-quality learning environment. Area residents were concerned that a “typical” modular building would decrease property values. The project architect, ATS&R developed a design that included site-installed brick & horizontal lap siding to match the existing school and blend with the surrounding properties. The school district had an aggressive two and half month timeline for full project completion. They held a public bid in which IMS was the low bidder. IMS had worked with the school district in the past and the district was confident that IMS would work with the architect, school board, and modular manufacturer to accomplish the common goal.

Location: Minnesota

Size: 9,800 ft²

Solution:

The solution, developed by the architect and implemented by IMS, combined the remodeling of an elementary school and the addition of a modular building to create the Anoka Middle School for the Arts, Washington Campus. The modular building includes classrooms for Art, Science, Social Studies, Music, Theater and Band along with mechanical rooms, technology rooms and restrooms. The building’s interior finishes mirror those of the existing building including painted gypsum walls, suspended ceilings, tiled floors and a sprinkler system.

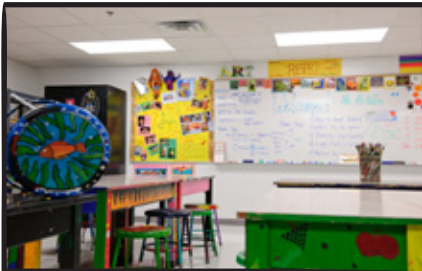

High efficiency, natural gas, roof-top HVAC units were utilized to increase the energy savings in heating and cooling the building. These rooftop units also improved the appearance of the modular building making it more aesthetically pleasing to the surrounding community. The classrooms were also outfitted with CO2 sensors and programmable thermostats. The additional features ensure quiet, comfortable, consistent airflow and optimal air quality, while allowing the district to control energy costs when the building is not in use. IMS along with all parties involved worked together to bring the project to completion on time. The district now has a visually appealing educational building as well as an exceptional learning environment, satisfying teachers, students, parents and the surrounding residential community.

Magnet School for the Arts

Minnesota



Location: Minnesota

Size: 9,800 ft²

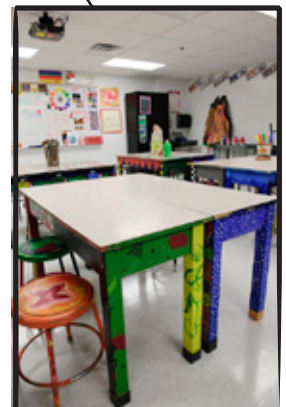
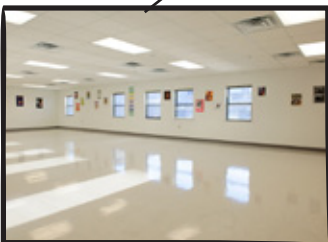
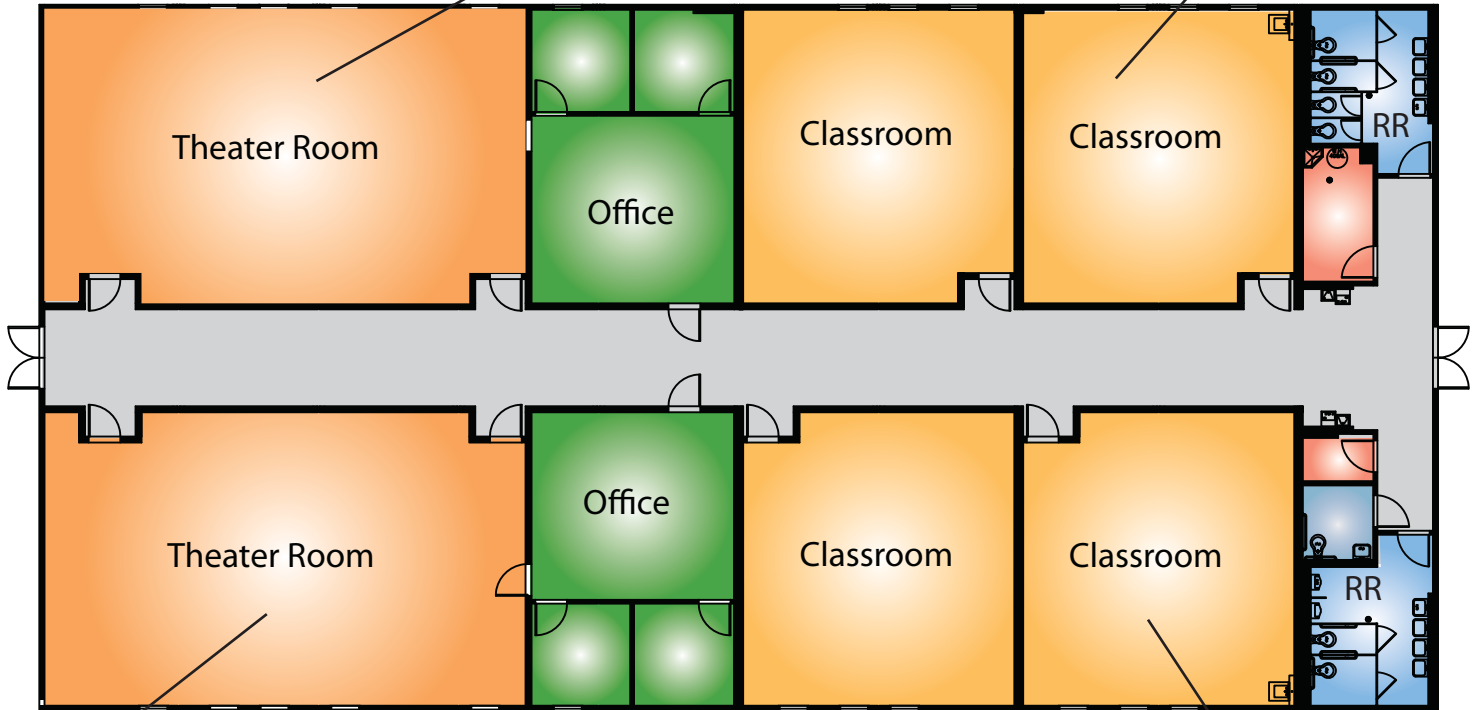

Innovative**Modular**
solutions