

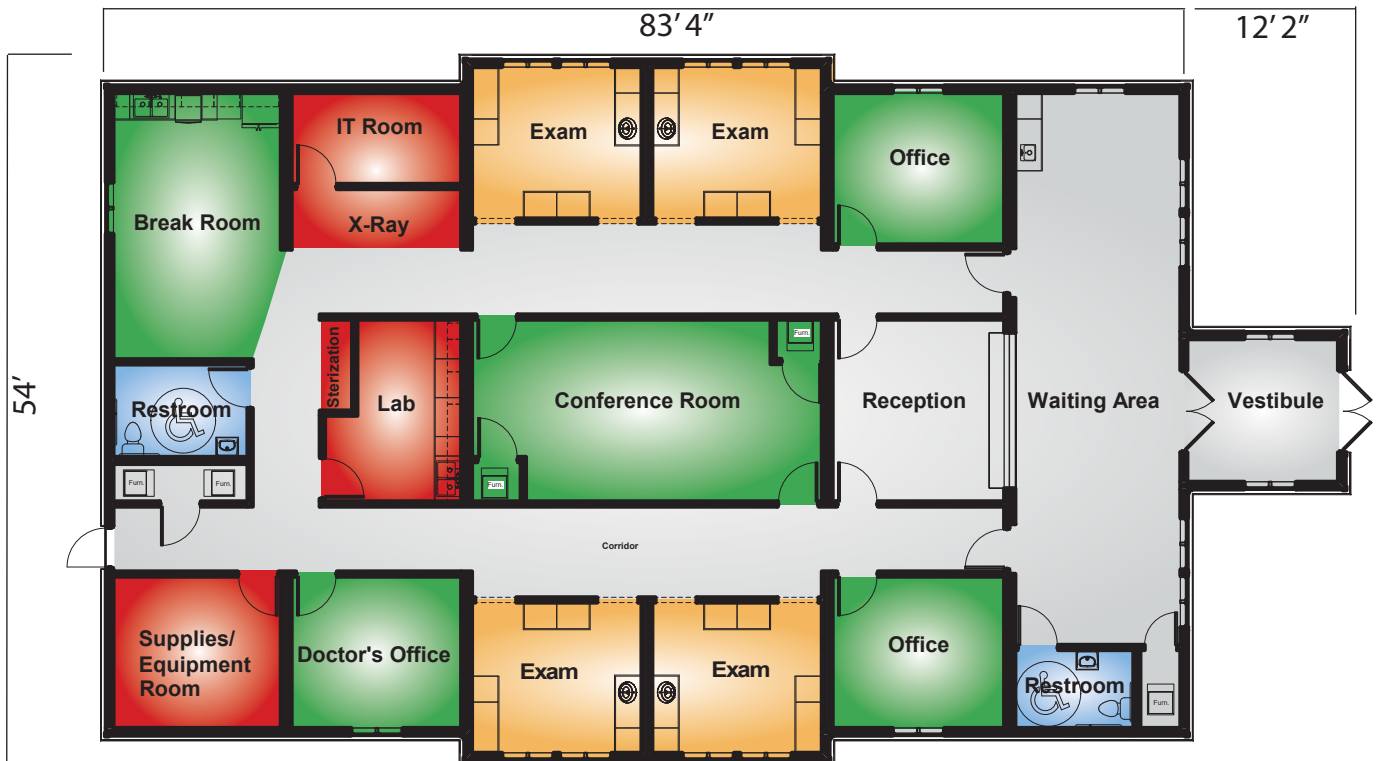

MODULAR

Dental, Medical or
Vet Clinic

4450 ft²



ABOUT Innovative Modular Solutions

From the first contact to moving into your modular building, IMS provides a dedicated team to ensure our customers are completely satisfied with their project. Customers are never passed off to another team member after beginning the project, but instead our Sales Managers, Project Managers, and project support staff work as one to provide the consistent service our company prides itself on.