

IMS Building Solutions for the Future

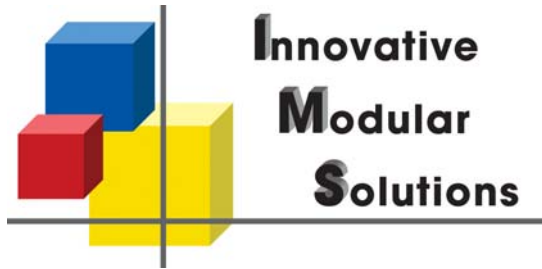

Challenges:

On June 9, an arson fire caused \$4.5 million damage to high school classrooms and administrative offices in an Illinois school district building.

The district administrators were uncertain how to plan for school for the fall. IMS representatives met with administrators in mid June to discuss potential modular building options. Shortly thereafter, IMS began working with the District's architect to further discuss options. The site was inspected and the immediate needs of the district were determined.

Alternatives Reviewed:

1. Renovate the damaged building - not feasible due to the extent of the damage and time constraints.
2. Occupy available space in other buildings in town - not feasible due to location and type of space available.
3. Install numerous 1 or 2-classroom modular buildings - not practical due to limited space on school grounds.
4. Install 1 large and 2 small modular buildings on the school grounds - the preferred Innovative Modular Solution.

Solution:

The District contracted with IMS in mid July to provide one building housing 7 classrooms, an open area for lockers and an administrative office. Two other buildings housed science classrooms, home economics classrooms, and a teacher's resource center. Delivery of the modular components started on July 31, and installation began immediately. All three buildings were fully furnished and operational by the first day of school in late August.

Benefits of this solution are as follows:

- Students remain on campus and have access to facilities (gymnasium and cafeteria) in the undamaged portions of the main building.
- Renovation of the school occurred without disruption to school activities.
- Cost effective and energy efficient modular buildings were installed prior to the start of the new school year.
- Modular buildings fit in available space on school grounds.

We would appreciate the opportunity to earn your business.



Offices in IL, IN, MI, MN and OH

Phone: 1-800-357-4699

Website: www.innovativemodular.com

E-mail: schools@innovativemodular.com

Modular Building Case Study

Public High School Fire



Our goal is to provide customer-focused, professional service that will exceed your expectations.



Quotes in the news:

June (Superintendent) "It's just going to take time," he said, wondering how the district could place 12 portable classrooms in the mainly residential area. "I don't know how we could do that in a small town like this."

June "High school principal assured students and parents Thursday at the Lexington school board meeting that 'we won't just survive this year, we will flourish.'"

August "One advantage to the modular buildings is air conditioning. During orientation, the principal said the school won't have to cancel classes this year because of heat days."

March of the following year "I'm very pleased with how the year has gone," said the superintendent of schools. "The kids and teachers have adapted quite well. The buildings have held up well and life goes on."

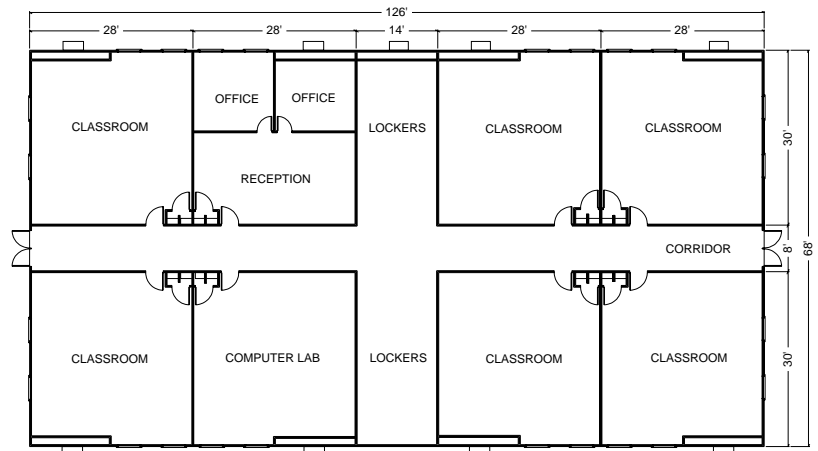

Offices in IL, IN, MI, MN and OH
Phone: 1-800-357-4699
Website: www.innovativemodular.com
E-mail: schools@innovativemodular.com



The information contained herein is proprietary to Innovative Modular Solutions and may not be used, reproduced, or disseminated without written consent.

Permanent or Temporary Building Solutions